

## CKDC VISIDIPPER WIDE ICE CREAM DIPPING CABINETS/GELATO CASES

The CKDC VISIDIPPER WIDE models offer optimum performance, consistent interior temperature, a large viewing/display area with LED lighting brilliantly illuminating the ice cream products. The curved triple pane heated glass is 4-1/2" lower than standard cabinets increasing viewing/display area by 35%.

The model is designed to accommodate gelato pan rack kits and gelato may be served from these cabinets.

The five inch stainless steel workspace at the rear of cabinet improves efficiency and convenience for the employee

The CKDC VISIDIPPER WIDE models are available in 8 hole, 12 hole and 16 hole models.



All products are certified for energy, safety and sanitation. NSF/ANSI 7 Standards

### FEATURES

- 20 Gauge steel cabinet with white powder coat paint interior & exterior
- Stainless steel curved front glass canopy & stainless steel top
- Triple pane heated front glass is 4-1/2" lower than standard cabinets
- Patented Kelvinator refrigeration design
- Digital temperature controller with LED Display
- Temperature Range +10°F to -15°F
- LED Lighting
- Plexi-glass lids
- Additional 5" stainless steel workspace at rear of cabinet
- Manual Defrost/Drain hose
- Energy star

### ACCESSORIES

- Can Skirt Kits
- Gelato Pan Rack Kits
- Frost Shield Kits
- Dipperwell Kit
- Caster Kit
- Leg Kit
- Shelf Kits
- Stainless Steel Exterior

# CKDC VISI-WIDE SERIES

## TECHNICAL DATA

MODEL	CKDC47V-W	CKDC67V-W	CKDC87V-W
Temp Range	+10°F to -15°F	+10°F to -15°F	+10°F to -15°F
<b>Exterior Dimensions</b>			
Length	46.5"	67"	88"
Depth	29.25"	29.25"	29.25"
Height	52.12"	52.12"	52.12"
<b>Capacity (cu. ft.)</b>			
Capacity (3-gal. tubs)	12	20	28
Facings (3-gal. tubs)	8	12	16
Storage (3-gal. tubs)	4	8	12
<b>Shipping Weight</b>			
Shipping Weight	565 lbs.	730 lbs.	850 lbs.
<b>Lighting</b>			
Lighting	LED	LED	LED
<b>Temp Control</b>			
Temp Control	Digital	Digital	Digital
<b>Electrical</b>			
Electrical	115/60/1	115/60/1	115/60/1
Rated Amps	11.5	12.5	12.5
<b>Electrical Information</b>			
Electrical Information	NEMA 5-15P	NEMA 5-15P	NEMA 5-15P

## SPECIFICATIONS

### Item CKDC47,67,87V-Wide

Furnish ( ) quantity, VisiDipper Wide Ice Cream Dipping Cabinets, Global model CKDC47V-Wide, CKDC67V-Wide, or CKDC87V-Wide. The unit construction shall consist of a 20-ga. white powder-coat finish galvanized steel interior & exterior, foamed in place.

Cabinets as specified to use R-404a refrigerant. Refrigeration control shall be digital thermostatic with a temperature range of +10°F to -15°F. Cabinet to have independent on/off switch for compressor and light switch mounted in the shell of the cabinet and to be furnished with a drain connection. Cabinet to be provided as a rear intake and front air discharge.

Cabinet to be UL, C-UL and NSF Certified.

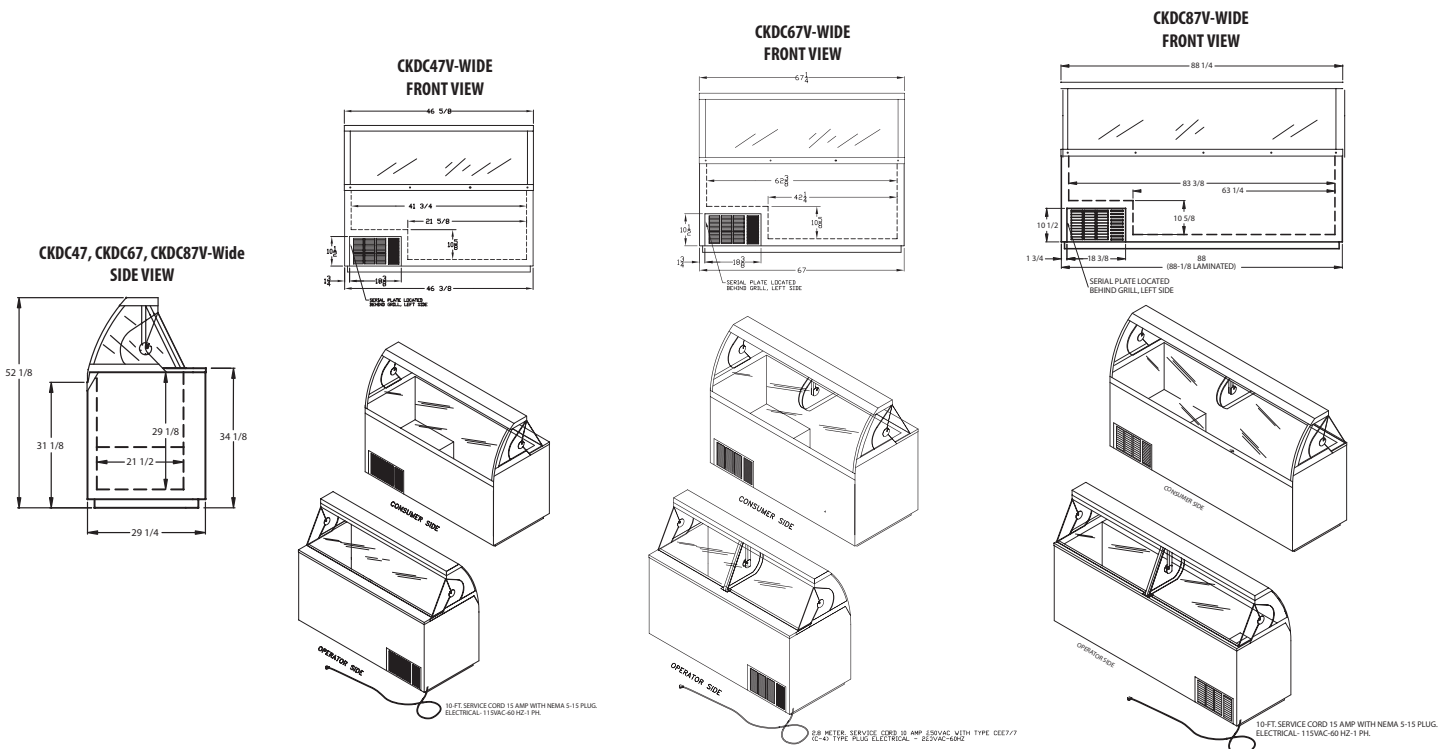
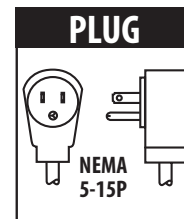

Cabinet designed for optimum performance in air-conditioned area at 70°F to 75°F ambient temperature and 50% to 55% relative humidity.

Global Refrigeration, Inc., reserves the right to change specifications, terms, and prices without notice.

**Global Refrigeration, Inc.**

5855 Grant Avenue, Cleveland, OH 44105

888.650.9799

www.globalref.com